

HIGH BAY | Stand-alone motion sensors with switching contact



Areas of application

- Suitable for high installation heights
- Industry
- Production halls

Product family benefits

- Energy savings up to 35 % (compared to manual switching)

Product family features

- Motion sensor with switching contact
- 3 to 10 m: detection of motion by people
- 3 to 13 m: detection of vehicle movement (e.g. fork lift truck)
- Adjustable switch-off delay: 30 s to 20 min
- Maximum power consumption in stand-by mode: 0.25 W

Product datasheet

Technical data

Electrical data

Nominal voltage	120...277 V
Mains frequency	50...60 Hz
System wattage	0.60 W

Dimensions & weight

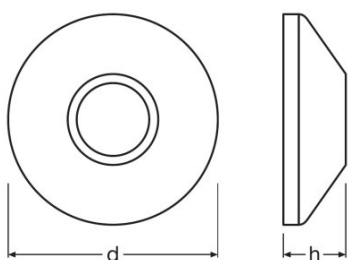

Diameter	116.0 mm
Height	40.0 mm
Product weight	135.00 g

Colors & materials

Product color	White
---------------	-------

Temperatures & operating conditions

Ambient temperature range	-10...+70 °C
---------------------------	--------------

Capabilities

Dimmable	No
Maximum installation height	13 m
Detection area	18 m ¹⁾
Detection angle	100 ° ²⁾
Load contact	5 A
Type of installation	On-top ceiling mounting

¹⁾ Maximum diameter

²⁾ Approximately

Certificates & standards

Product datasheet

Type of protection	IP20
Protection class	II









Logistical data

Commodity code	853650809000
----------------	--------------

Equipment / Accessories

- Suitable for up to 15 electronic control gears
- Installation by means of Mounting Adapter possible

Download Data

File
 Brochures 335611_Energy saving
 Brochures Light is the efficiency booster - LED-based industrial lighting (EN)
 Brochures Light is the efficiency booster - LED-based industrial lighting (DE)
 Declarations of conformity 334824_Declaration of conformity – Mounting Adapter
 Declarations of conformity EU Declaration of conformity HIGH BAY VISION SENSOR
 Installation/Operation notice 334311_Technical instructions
 Installation guide 334486_Mounting Adapter Technical instructions
 Installation guide 334723_Technical instructions

Logistical Data

Product code	Product description	Packaging unit (Pieces/Unit)	Dimensions (length x width x height)	Volume	Gross weight
4008321410078		Shipping carton box 20	238 mm x 260 mm x 448 mm	27.72 dm ³	3828.00 g

The mentioned product code describes the smallest quantity unit which can be ordered. One shipping unit can contain one or more single products. When placing an order, for the quantity please enter single or multiples of a shipping unit.

Product datasheet

Disclaimer

Subject to change without notice. Errors and omission excepted. Always make sure to use the most recent release.

HOANG KHAI DANG COMPANY LIMITED

The Importer and Distribution of lighting equipment OSRAM

Head office: 44 Nguyen Dinh Chieu, Da Kao Ward, District 1, Ho Chi Minh City, Viet Nam.

Tel: 028 3910 6667 - 028 3910 7778

Mail: hoangkhaidang@hkd.com.vn Website: <https://hkd.com.vn>

Facebook: <https://www.facebook.com/ledosram>

Hotline: 090 3030 555